



PARTS LIST

SHORT REACH TRIMMER

SRTZ2600

NOTE :

1. Use KOMATSU ZENOAH genuine parts as specified in the parts list for repair and/or replacement.
2. KOMATSU ZENOAH does not warrant the machines, which have been damaged by the use of any parts other than those specified by the company.
3. When placing parts orders for repair and/or replacement, check if the model name and the serial number are applicable to those specified in the parts list, then use parts number described in the parts list.
4. The contents described in the parts list are accurate as of the date and may change due to improvement.
5. The parts for the machine shall be supplied ten (10) years after the machine is discontinued. [It is possible that some specific parts may be subject to change of their delivery term and list price within the limit of ten (10) years after the machine is discontinued. It is also possible that some parts may be available even after the limit of ten (10) years.]

APPLICABLE SERIAL NUMBERS:

000101 and up

May 2000

Fig.1 DRIVE UNIT

Key#	PART NUMBER	DESCRIPTION	Q'TY /UNIT	NOTE	Key#	PART NUMBER	DESCRIPTION	Q'TY /UNIT	NOTE
1	T3075-12100	PIPE-COMP	1		21	3540-91120	• SPANNER	1	
2	T3075-12210	SHAFT	1		22	3540-91110	• BAR	1	
3	T3076-11330	GRIP-ASS'Y	1						
4	6420-17300	HANGER-ASS'Y	1						
5	6420-17400	• HANGER-COMP	1						
6	9366-17110	•• HANGER	1						
7	9366-17120	•• CLAMP	1						
8	6420-17410	•• SLEEVE	1						
9	0263-90525	• SCREW	1						
10	T3076-12510	NAME-PLATE	1						
11	3436-91170	CAUTION-PLATE	1						
12	6489-14000	HANDLE-ASS'Y	1						
13	6420-14311	• HANDLE	1						
14	6420-14320	• CLAMP	1						
15	0263-90535	• SCREW	4						
16	6489-17200	STRAP-ASS'Y	1						
17	3550-91000	TOOL-SET	1						
18	1030-91340	• DRIVER	1						
19	3239-91310	• SOCKET	1						
20	09007-00425	• WRENCH	1						

Fig.2 CUTTING UNIT

Key#	PART NUMBER	DESCRIPTION	Q'TY /UNIT	NOTE	Key#	PART NUMBER	DESCRIPTION	Q'TY /UNIT	NOTE
1	6598-13110	LEVER, clamp	1		38	T4008-13630	•• GEAR(C)	1	
2	0290-20615	WASHER	1	M6	39	_____	•• BOSS	1	
3	T3078-13130	WASHER	1	6x16x2.0	40	T4008-13650	•• SPRING	1	
4	6782-13140	ANGLE ADJUSTER	1		41	T4008-13660	•• PLATE	1	
5	0225-10612	BOLT	2	M6x12	42	T4008-13670	•• WASHER	1	
6	6782-13200	CASING A SET	1		43	T4008-13680	•• WASHER	1	
7	_____	• CASING A	1		44	0280-10605	• NUT	1	M6
8	6782-13220	• PLATE	1		45	0290-20615	WASHER	1	
9	3199-13350	GREASE FITTING	3		46	6598-13620	O-RING	1	P41
10	T3078-13250	LABEL	1		47	04065-02612	SNAP RING	1	
11	0263-10408	SCREW	2	M4x8	48	06004-06000	BEARING	1	
12	6598-13320	COVER	1		49	6780-13710	CASING B	1	
13	6598-13330	SNAP RING	1		50	6598-13330	SNAP RING	1	
14	6782-13340	BEBEL GEAR	1		51	0225-10612	BOLT	1	M6x12
15	04065-02612	SNAP RING	1		52	6782-13720	WASHER	1	5x10x1.0
16	06004-06000	BEARING	1		53	01252-30510	BOLT	1	M5x10
17	6782-13370	CRANK SHAFT	1		54	3350-21320	BOLT	1	M5x30
18	04064-02815	SNAP RING	1		55	6782-13810	JOINT	1	
19	T3078-13410	BLADE	2		56	6598-13820	GEAR SHAFT B	1	
20	6782-13430	BEARING	1	608Z	57	6782-13830	BEARING	2	6900RS
21	6782-13440	COVER	1		58	04065-02212	SNAP RING	1	
22	6782-13450	BOLT	4	M4x10	59	6782-13850	BEVEL GEAR	1	
23	6782-13460	FELT	1		60	6598-13330	SNAP RING	1	
24	3884-11750	SCREW	1		61	6598-13860	PACKING	1	
25	3880-11780	WASHER	6		62	6598-13870	COVER	1	
26	6598-13510	SCREW	5	L17	63	0263-10408	SCREW	2	M4x8
27	6598-13530	SCREW	2	M5x20	64	T3078-13910	BLADE COVER	1	
28	T3078-13540	GUIDE PLATE	1						
29	6782-13550	PLATE	1						
30	6782-14470	NUT	2	M5					
31	3880-11790	NUT	4	M6					
32	6782-13650	WASHER	1	6x15x2.0					
33	6598-13430	BEARING	1	608 2RS					
34	04065-02212	SNAP RING	1						
35	T4008-06010	SHAFT KIT	1						
36	_____	•• SHAFT	1						
37	_____	•• GEAR(B)	1						

Fig.3 ENGINE UNIT

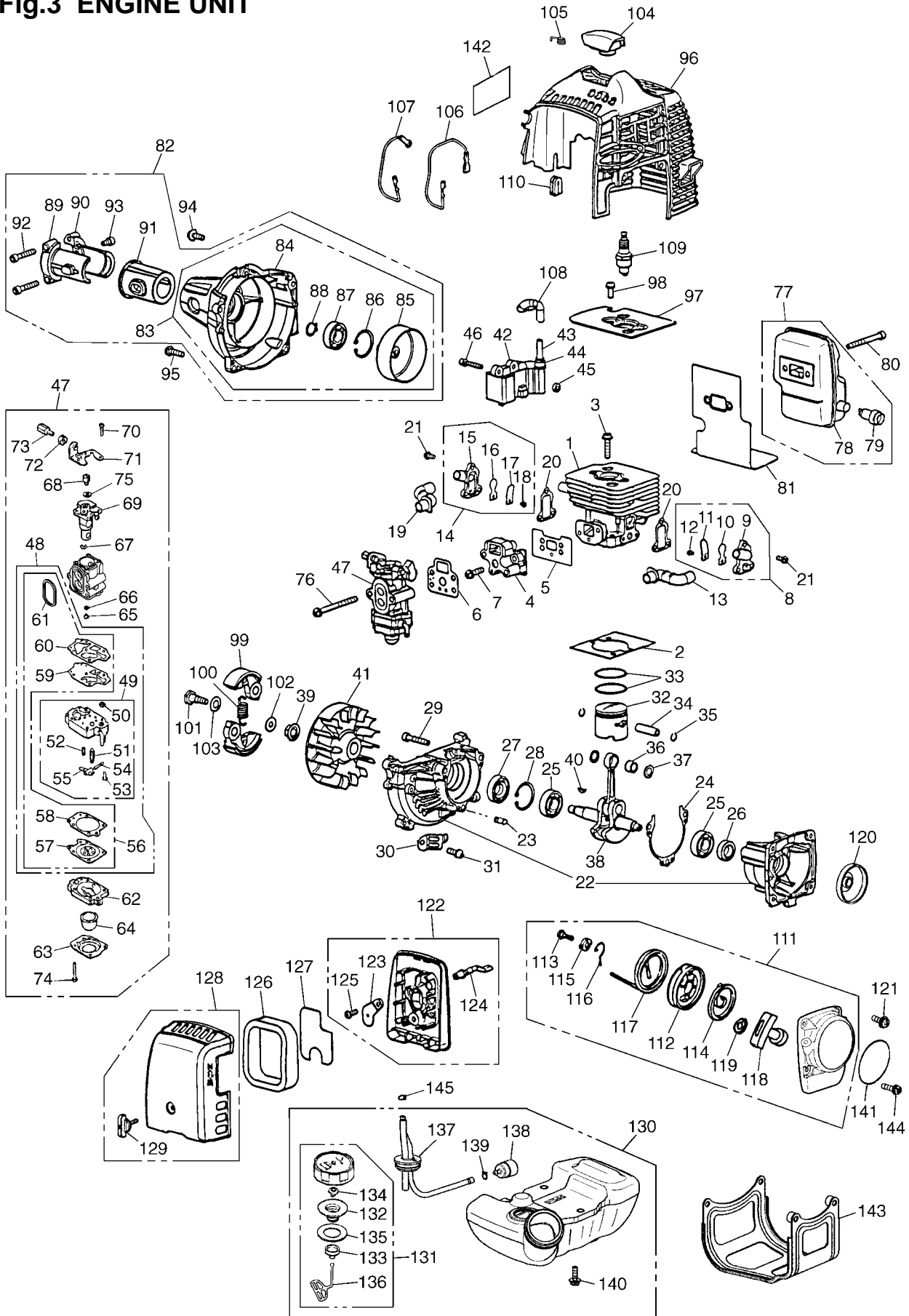

Fig.3 ENGINE UNIT

Key#	PART NUMBER	DESCRIPTION	Q'TY /UNIT	NOTE	Key#	PART NUMBER	DESCRIPTION	Q'TY /UNIT	NOTE
1	4810-12111	CYLINDER	1		74	1850-81530	• SCREW	4	
2	4810-12210	GASKET, base	1		75	5500-81160	• WASHER	1	
3	1850-12130	BOLT	2	M5x22	76	0263-90560	SCREW	2	M5x60
4	4810-13161	INSULATOR	1		77	4810-15100	MUFFLER ASS'Y	1	
5	4810-13120	GASKET, insulator	1		78	4810-15111	• MUFFLER	1	
6	4810-13130	GASKET, carburetor	1		79	4810-15140	• ARRESTER	1	
7	0263-90520	SCREW	2	M5x20	80	01252-30550	BOLT	2	M5x50
8	4810-16100	REEDVALVE (S)-A	1		81	4810-15410	GASKET	1	
9	4810-16110	• VALVECASE (S)	1		82	4810-31000	COVER-A	1	
10	4810-16120	• REEDVALVE	1		83	4810-31100	• COVER-C	1	
11	4810-16130	• STOPPER	1		84	4810-31110	•• COVER, fan	1	
12	4810-16170	• SCREW	1	M3x8	85	4810-31120	•• DRUM	1	
13	4810-16150	PIRE AIR (S)	1		86	04065-02812	•• SNAPRING	1	
14	4810-16200	REEDVALVE (F)-A	1		87	06004-06001	•• BEARING	1	
15	4810-16210	• VALVECASE (F)	1		88	04064-01210	•• SNAP RING	1	
16	4810-16120	• REEDVALVE	1		89	6470-31211	• BRACKET (A)	1	
17	4810-16130	• STOPPER	1		90	6470-31221	• BRACKET (B)	1	
18	4810-16170	• SCREW	1	M3x8	91	6470-31230	• CUSHION	1	
19	4810-16160	PIPE AIR (F)	1		92	01252-30530	• BOLT	2	M5x30
20	4810-16140	GASKET, valve	2		93	01252-30514	• BOLT	1	M5x14
21	4810-16180	SCREW	6		94	5500-85510	SCREW	1	M5x16
22	4810-21100	CRANKCASE-C	1		95	0263-90520	SCREW	4	M5x20
23	2629-21130	• PIN	3		96	4810-32111	COVER, engine	1	
24	4810-21140	GASKET	1		97	4810-12310	PLATE	1	
25	06030-06001	BEARING	2		98	0263-90510	SCREW	2	M5x10
26	4810-21210	SEAL	1		99	1140-51111	SHOE	2	
27	1850-21220	SEAL	1		100	1600-51223	SPRING	1	
28	04065-02812	SNAP RING	1		101	1140-51250	SCREW	2	
29	01252-30530	BOLT	3	M5x30	102	1140-51230	WASHER	2	
30	4810-22110	GUARD	1		103	1970-51241	WASHER	2	
31	0263-90510	SCREW	1	M5x10	104	4810-72110	CAP	1	
32	4810-41110	PISTON	1		105	1900-72120	SPRING	1	
33	5910-41210	RING	2		106	4810-71240	CORD	1	
34	1600-41310	PIN	1		107	4810-71250	CORD, earth	1	
35	1260-41320	RING	2		108	2850-71320	TUBE	1	
36	1140-41330	BEARING	1		109	4810-73110	PLUG	1	
37	1101-41340	WASHER	2		110	4810-72120	GROMMET	1	
38	4810-42000	CRANKSHAFT-C	1		111	4810-75100	RECOIL ASS'Y	1	
39	1650-43230	NUT	1		112	4500-75120	• REEL	1	
40	1000-43240	KEY	1		113	4500-75150	• SCREW	1	
41	5501-71110	ROTOR	1		114	1850-75130	• SPRING, spiral	1	
42	4810-71200	COIL-A	1		115	4500-75180	• COLLAR	1	
43	4810-71220	• CORD	1		116	4500-75190	• ARM	1	
44	2616-71320	• CAP	1		117	4810-75160	• ROPE	1	
45	1260-71261	SPACER	2		118	3330-75421	• KNOB	1	
46	4500-72150	BOLT	2	M4x22	119	4810-75170	• PLATE, stopper	1	
47	4810-81001	CARBURETOR ASS'Y	1		120	4500-75210	PULLEY	1	
48	4810-06030	• REBUILD KIT	1		121	5500-85510	SCREW	2	M5x16
49	4810-81450	•• BODY ASS'Y	1		122	4810-82100	BODY ASS'Y	1	
50	_____	••• SCREEN	-		123	4810-82130	• PLATE, choke	1	
51	_____	••• VALVE	-		124	5500-82140	• LEVER, choke	1	
52	_____	••• SPRING	-		125	2630-33610	• SCREW	1	
53	_____	••• SCREW	-		126	4810-82170	ELEMENT	1	
54	_____	••• PIN	-		127	4810-82180	SCREEN	1	
55	_____	••• LEVER	-		128	4810-82200	COVER ASS'Y	1	
56	4810-06020	•• GASKET KIT	1		129	5500-82221	• KNOB	1	
57	_____	••• DIAPHRAGM	-		130	T1504-85001	TANK ASS'Y	1	
58	_____	••• GASKET, diaphragm	-		131	T1015-85201	• CAP ASS'Y	1	
59	_____	••• DIAPHRAGM, pump	-		132	4500-85230	•• HOLDER	1	
60	_____	••• GASKET, pump	-		133	5600-85240	•• CAP	1	
61	4810-81130	••• RING	1		134	5600-85250	•• VALVE	1	
62	1850-81490	• BODY, purge	1		135	4500-85220	•• PACKING	1	
63	1850-81520	• COVER, pump	1		136	3317-57242	•• STOPPER	1	
64	1751-81510	• PUMP, priming	1		137	5500-85300	• PIPE COMP.	1	
65	4810-81251	• JET	1		138	5500-85400	• FLTER ASS'Y	1	
66	1751-81240	• O-RING	1		139	1260-85460	• CLIP	1	
67	1751-81130	• RING	1		140	5500-85510	SCREW	3	M5x16
68	1881-81140	• SWIVEL	1		141	T1504-75410	LABEL, recoil	-	
69	_____	• VALVE ASS'Y	-		142	T1504-31130	LABEL, cover	1	
70	1752-81110	• SCREW	2		143	4810-31911	GUARD	1	
71	5500-81120	• BRACKET	1		144	0263-90525	SCREW	2	
72	1751-81180	• NUT, adjuster	1		145	1950-86120	CLIP	1	
73	1918-81170	• SCREW, adjuster	1						

[Gardening Tools](#)
[Direct - Leaders in](#)
[Garden Machinery](#)

Blower Vacs	Brushcutters	Brush cutters	Chainsaws
Chain saws	Cultivators	Cylinder Lawn Mowers	Cylinder Mowers
Echo Chainsaws	Echo Strimmers	Electric Chainsaws	Fertiliser Spreaders
Garden Blowers	Garden Rollers	Garden Shredders	Garden Tractors
Garden Vacuums	Hayter Lawn Mowers	Hedge Cutters	Hedgecutters
Hover Mowers	Husqvarna Chainsaws	Kawasaki Brush Cutters	Kawasaki Strimmers
Lawn Mowers	Lawn Scarifiers	Lawn Tractors	Leaf Blowers
Leaf Vacuums	Petrol Chainsaws	Petrol Hedge Cutters	Ride on Lawn Mowers
Ride on Mowers	Rotary Mowers	Rotavators	Ryobi Strimmers
Scarifiers	Strimmers	Westwood Lawn Tractors	Westwood Ride on Mowers
Westwood Tractors	Petrol Strimmers	Kawasaki Petrol Strimmers	Echo Petrol Strimmers
Petrol Lawn Mowers	Petrol Garden Mowers	Rotary Lawn Mowers	Hayter Garden Mowers
Husqvarna Petrol Chainsaws	Echo Chain Saws	Petrol Chain Saws	Kawasaki Hedge Cutters
Kawasaki Hedgecutters	Garden Hedge Cutters	Electric Hedge Cutters	Allen Hover Mowers
Echo Petrol Chainsaws	Electric Hedgecutters	Rally Ride On Mower	Rally Garden Tractors
Leaf Hoovers	Bosch Hedge Cutters	Bosch Hedge Trimmers	Hedge Trimmers
Petrol Hedge Trimmers	Garden Hedge Trimmers	Garden Roller	Lawn Roller
Rollers	Fertilizer Spreaders	Fertilizer Sprayers	Fertiliser Sprayers
Garden Sprayer	Garden Rotavators	Garden Cultivators	Electric Garden Shredders
Outdoor Shredders	Garden Shredders UK	Petrol Shredders	Lawn Mowers UK
Petrol Rotary Lawn Mowers	Petrol Cyliner Lawn Mowers	Atco Lawn Mowers	Sit on Lawn Mowers
Garden Strimmers	Garden Chainsaws	Backpack Sprayers	Knapsack Sprayers
Pesticide Sprayers	Midgeater Plus	Home Brush Cutters	Home Brushcutters
Snow Sledges	Trampolines	Go Karts	Gritters
Petrol Brush Cutters	Ryobi Brush Cutters	Petrol Garden Strimmers	Hayter Ranger 48 Autodrive
Lawn Sweepers	Leaf Collectors	Petrol Brush Cutters	Petrol Rotary Lawn Mowers

Garden Vacs	Gardena Hedge Cutters	Husqvarna Garden Tractors	Kawasaki Brushcutters
Backpack Blowers	Blower Vac Range	Discounted Brushcutters	Echo Petrol Chainsaws
Three Great Lawn Mowers	Discounted Lawn Mowers	Brush Cutter Selection	Atco Lawn Mowers
Kawasaki Brushcutters	Discounted Brushcutters	Grit Spreaders	Salt Spreaders
Husqvarna Rider Tractors	Sledges		